

MAULDING

FLOOR 1

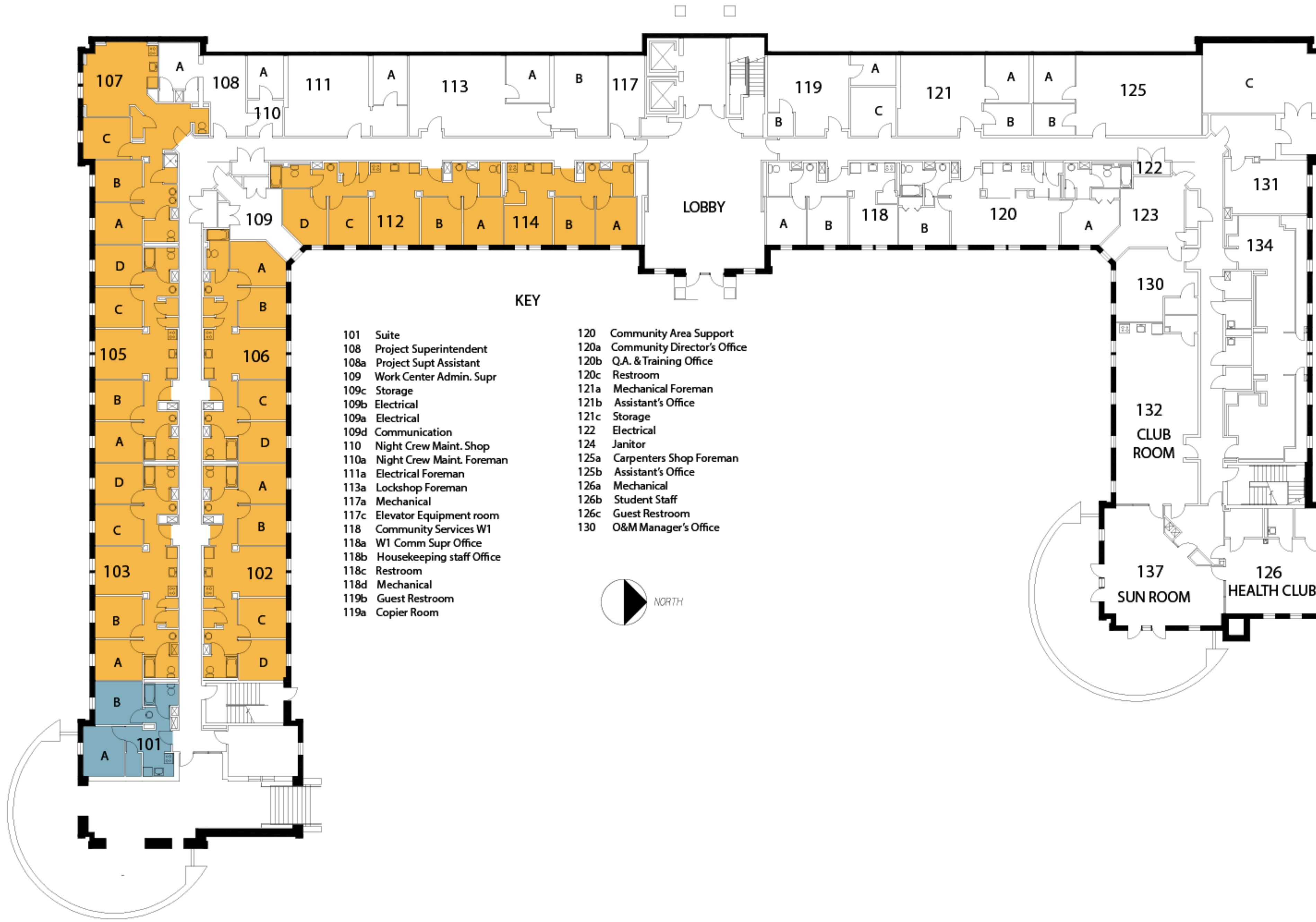

KEY

- | | |
|--------------------------------|----------------------------------|
| 101 Suite | 120 Community Area Support |
| 108 Project Superintendent | 120a Community Director's Office |
| 108a Project Supt Assistant | 120b Q.A. & Training Office |
| 109 Work Center Admin. Supr | 120c Restroom |
| 109c Storage | 121a Mechanical Foreman |
| 109b Electrical | 121b Assistant's Office |
| 109a Electrical | 121c Storage |
| 109d Communication | 122 Electrical |
| 110 Night Crew Maint. Shop | 124 Janitor |
| 110a Night Crew Maint. Foreman | 125a Carpenters Shop Foreman |
| 111a Electrical Foreman | 125b Assistant's Office |
| 113a Lockshop Foreman | 126a Mechanical |
| 117a Mechanical | 126b Student Staff |
| 117c Elevator Equipment room | 126c Guest Restroom |
| 118 Community Services W1 | 130 O&M Manager's Office |
| 118a W1 Comm Supr Office | |
| 118b Housekeeping staff Office | |
| 118c Restroom | |
| 118d Mechanical | |
| 119b Guest Restroom | |
| 119a Copier Room | |

